

# RUSSET

(Plots 1, 2, 3, 4, 7, 9, 12, 14 & 20) 4 bedroom house

DUGDALE DRIVE | WARNDON | WORCESTER | SAT NAV WR4 0QR



Computer generated image only, details will vary.

THESE FOUR BEDROOM DETACHED HOMES ENJOY A LARGE FAMILY KITCHEN WITH SEPARATE DINING ROOM AS WELL AS AN ENVIUS DUAL ASPECT LIVING ROOM.



WORCESTERSHIRE COUNTRYSIDE

# RUSSET

(Plots 1, 2, 3, 4, 7, 9, 12, 14 & 20) 4 bedroom house



Site plan not to scale.

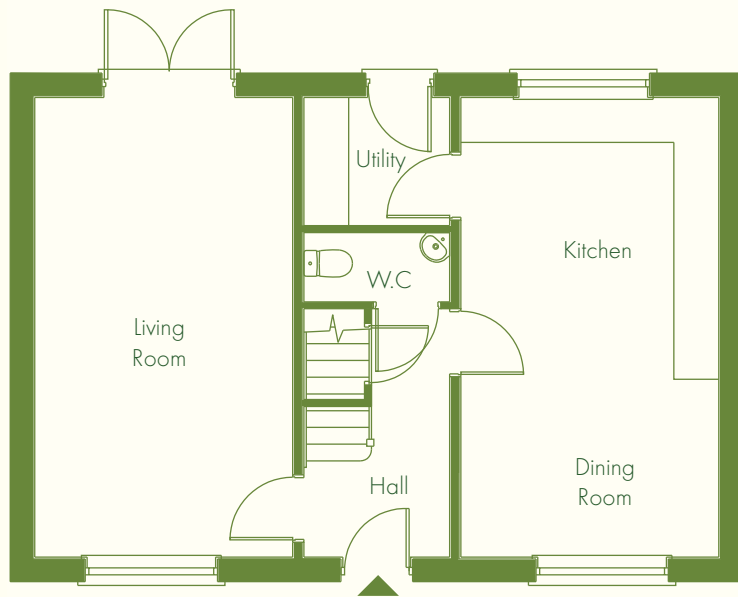

## GROUND FLOOR

Kitchen/Dining Room	3450mm x 6150mm (11'4" x 20'2")
Living Room	3450mm x 6150mm (11'4" x 20'2")
Utility	1714mm x 1950mm (5'7" x 6'5")

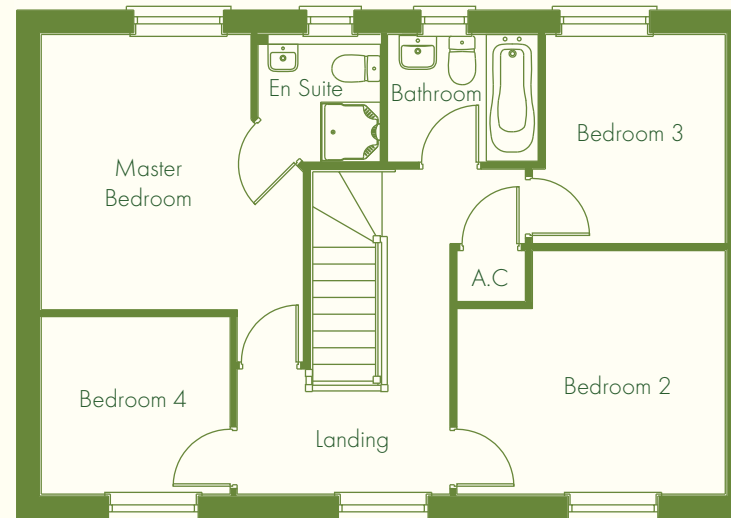

## FIRST FLOOR

Master Bedroom	3507mm x 3682mm (11'6" x 12'1")
En Suite	1707mm x 1638mm (5'7" x 5'4")
Bedroom 2	3590mm x 3260mm (11'9" x 10'8")
Bedroom 3	2407mm x 2797mm (11'9" x 10'8")
Bedroom 4	2528mm x 2375mm (8'4" x 7'10")
Bathroom	2019mm x 1707mm (6'7" x 5'7")

Floor plans not to scale. All dimensions are approximate maximum room sizes and should not be relied upon for flooring or furniture placement.

