

# PIPPIN

(Plots 25, 26 & 27) 2 bedroom house

DUGDALE DRIVE | WARNDON | WORCESTER | SAT NAV WR4 0QR

ORCHARD



W A L K



Computer generated image only, details will vary.

THESE TWO BEDROOM MEWS HOUSES ENJOY A MORE TRANQUIL POSITION ON THE DEVELOPMENT AND ARE IDEAL FOR THE FIRST TIME BUYER.



WORCESTER CITY CENTRE

# PIPPIN

(Plots 25, 26 & 27) 2 bedroom house



Site plan not to scale.

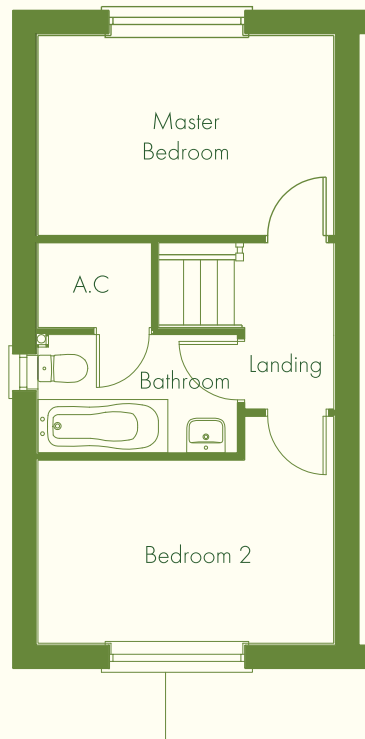
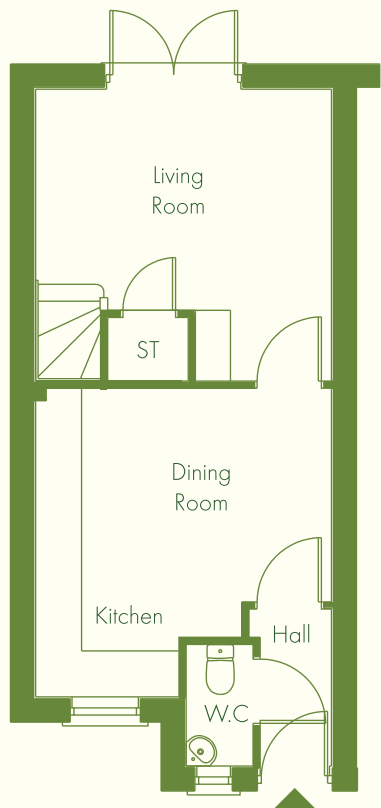

## GROUND FLOOR

Kitchen/Dining Room	3807mm x 3858mm (12'6" x 12'8")
Living Room	4024mm x 3858mm (13'2" x 12'8")

## FIRST FLOOR

Master Bedroom	3858mm x 2608mm (12'8" x 8'7")
Bedroom 2	3858mm x 2390mm (12'8" x 7'10")
Bathroom	2602mm x 1541mm (8'6" x 5'1")

Floor plans not to scale. All dimensions are approximate maximum room sizes and should not be relied upon for flooring or furniture placement.

